

GLEIPNIR OFFSHORE BANANA CHUTE BLOCK

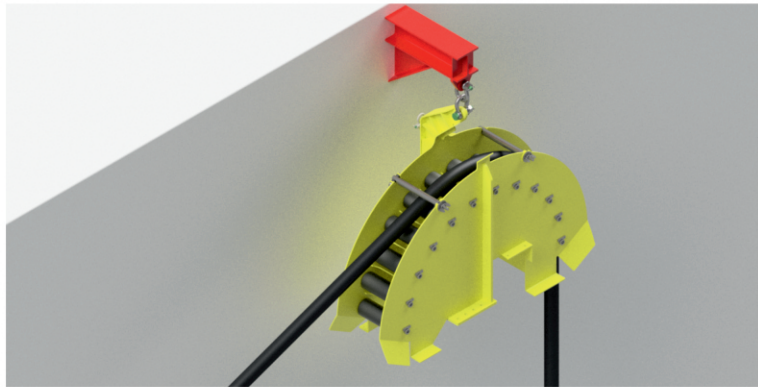

Gleipnir offshore Banana Chute Block is a universal way for overboard handling of umbilical/hose/cable. Can be used in 3 different configurations:



Working position A
Hanging block. By means of shackle can be connected to the interference structure or crane.

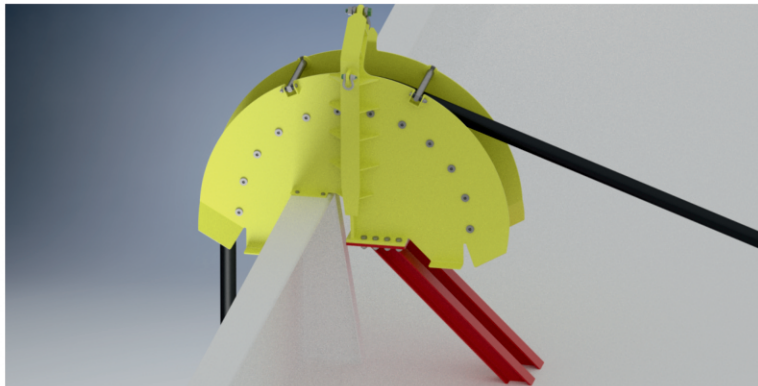

Working position B
Fixed chute on bulwark. Block can be fixed to the bulwark by means of interchangeable bolted saddle.

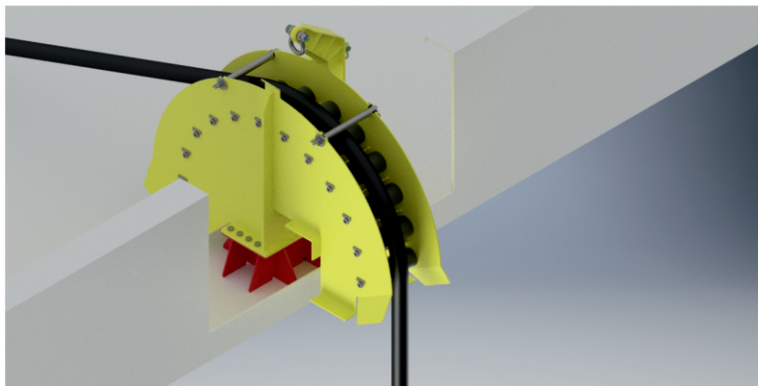

Working position C
Fixed chute on foundation. Block can be fixed to the interference structure by means of foundation plate.

**Range of wire pull and bending diameter available upon request.
Components in red color (support structures) can be delivered as an option respect to deck interference.
Design and production respect to DNVGL-ST-0377 and DNVGL-ST-0378 standards.**

In case of any questions please do not hesitate to contact GLEIPNIR.