

GLEIPNIR TRAWL BLOCKS SERIES

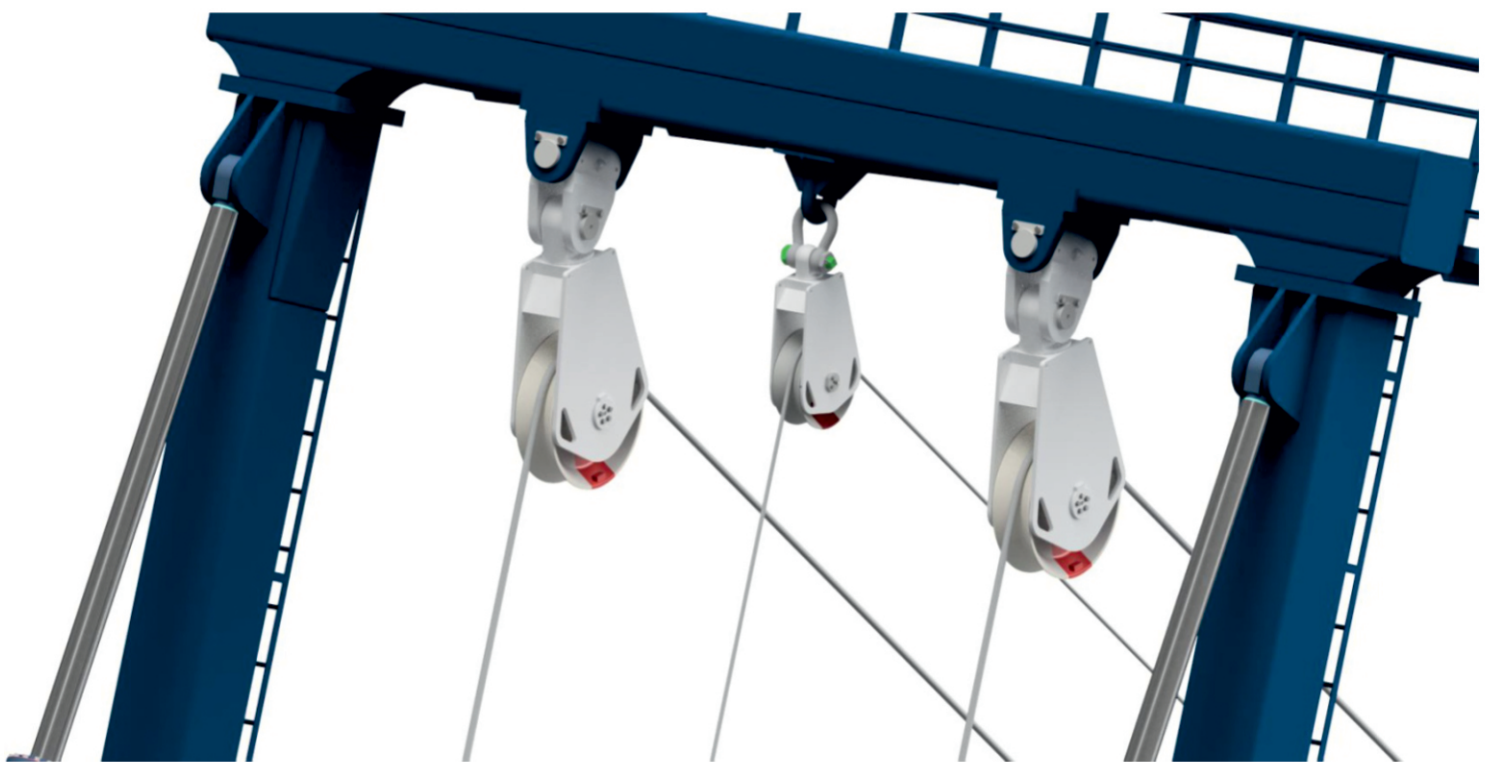

Trawl / Purse seine series which combines high quality and durability with high cost efficiency. This series is a result of recognizing and meeting market needs, and two decades of experience.



Trawl block selection guide

To select the correct trawl block size for your application, the following information is required:

- SWL (wire pull) in Tons;
- System geometry (wrapped / working angle for each block);
- Sheave diameter.

Below, classic arrangement of trawl block is shown. To avoid selection of oversized block, description of two angles has been provided:

- Wrapped angle - α° - angle between lines perpendicular to load lines .
- Working angle - β° - angle between load and load lines.

The angles α° and β° , is normally max 180°

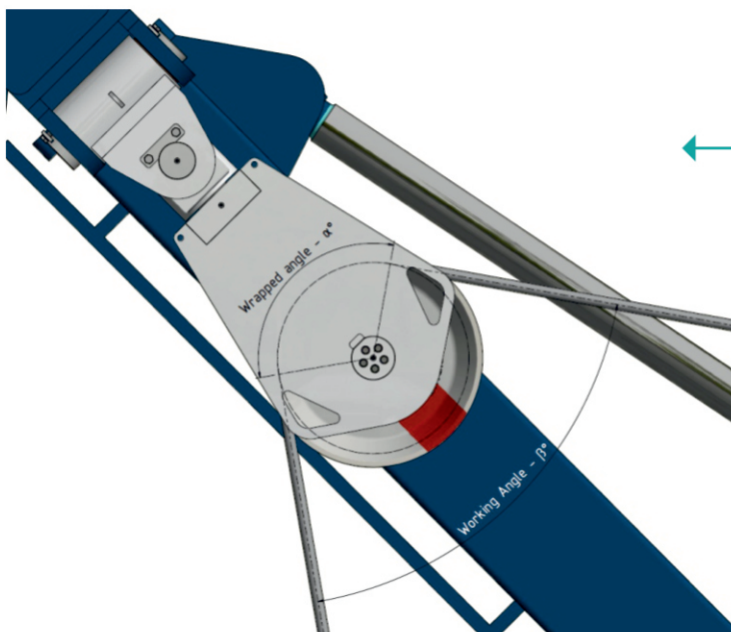

Based on received information, the SWL (wire pull) shall be multiplied by factor, selected acc. to table 1.1.

Trawl block selection guide

Wrapped angle - α°	Working angle - β°	Multiplication factor
180°	0°	2.00
170°	10°	1.99
160°	20°	1.97
150°	30°	1.93
140°	40°	1.87
135°	45°	1.84
130°	50°	1.81
120°	60°	1.73
110°	70°	1.64
100°	80°	1.53
90°	90°	1.41
80°	100°	1.29
70°	110°	1.15
60°	120°	1.00
50°	130°	0.86
45°	135°	0.76
40°	140°	0.68
30°	150°	0.52
20°	160°	0.35
10°	170°	0.17

Table 1.1

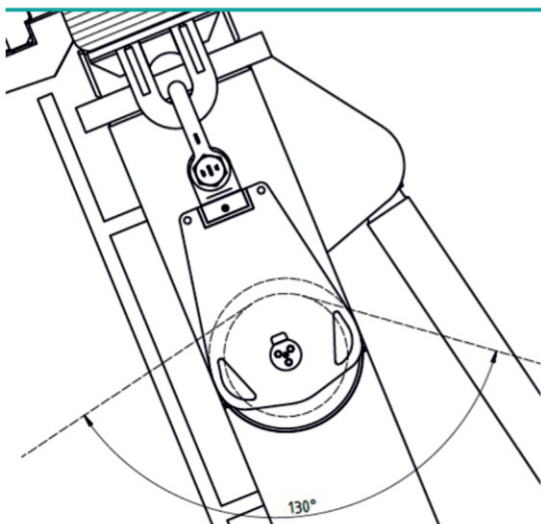

Input data:

SWL (wire pull) = 45T

β° , Working angle = 130°

Needed block size:

SWL (in headfitting) = 45T * 0.86 = 38.7 T

Based on received result, a great choice of selection for this application is Trawl block - $\varnothing 500$ - 42,5T - article number 04040.

Standard Gleipnir Trawl block sizes

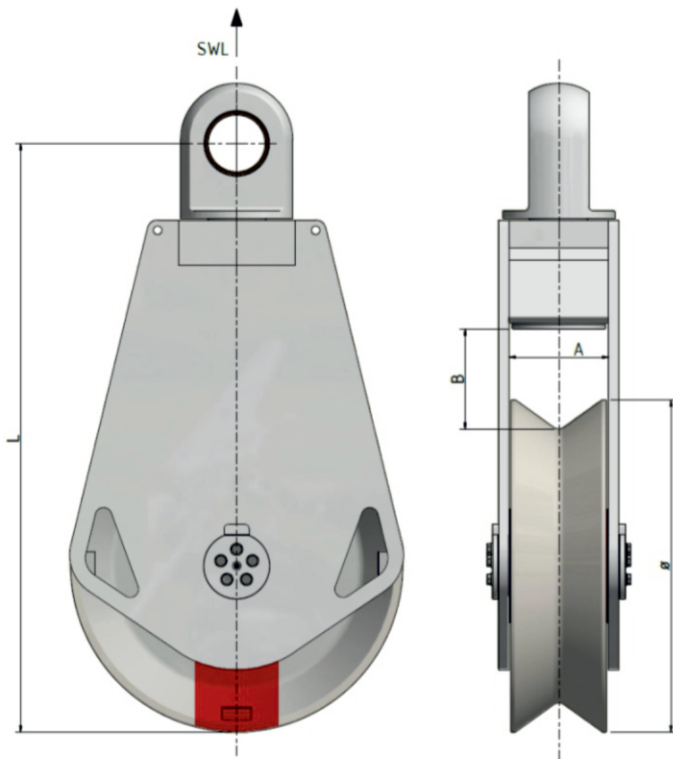

Different types of top connection:

1. Headfitting for use of standard shackle.
2. Headfitting for use of Gleipnir Trawl Block hinge.

Wire size to be specified by customer.
Other designs/loads will be available upon request.
Additional charges if third party verification is required.

Article no.	SWL in headfitting [T]	Sheave diameter [mm]	Width between sideplates - A [mm]	Block opening size - B [mm]	Length from the center of headfitting - L [mm]	Weight [kg]	Type of connection
04000	12	ø170	100	100	392	25	1
04010	12	ø250	120	120	479	41	1
04020	25	ø300	140	140	640	76	1
04030	35	ø400	180	180	794	166	1
04040	42,5	ø500	180	180	903	200	1
04050	60	ø600	180	180	1071	302	2
04060	60	ø700	240	240	1203	443	2
04080	80	ø800	240	240	1343	605	2
04070	120	ø800	240	240	1417	736	2
04090	120	ø1000	260	260	1637	1166	2